

ROTARY CLOTHESLINE V1.0

M32/M38/M42/M48/M52/M58

Daytek®



HOW TO RESTRING/REPLACE THE LINE ON A DAYTEK ROTARY CLOTHESLINE

1. **Tensioner Block Bottom** – recessed into the arm of the clothesline.
2. **Tensioner Block Top** – positioned on top of the bottom block.
3. **Bolt** – head of bolt under the arm of the clothesline.
4. **Nut** – seated in the top of the line tensioner.

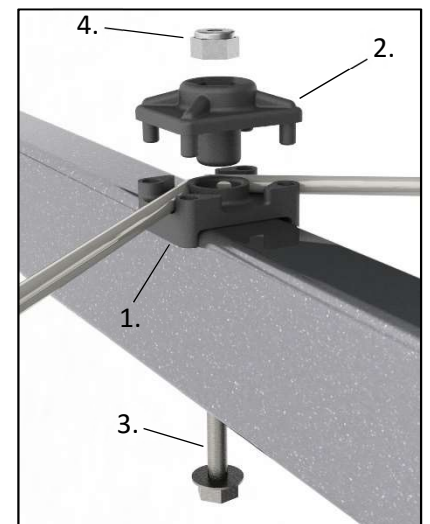

To replace a line on your Daytek Rotary Clothesline, you must remove the Tensioner Block Tops of the effected line.

To remove the Tensioner Block Tops,

- a) Place your index finger on top of the Tensioner Block and over the Nut to ensure that the Nut is held in position.
- b) Undo and loosen the bolt from under the arm of the clothesline. Once the bolt is fully loose, you can carefully remove the Tensioner Block Top & Nut.
- c) Remove the line from the Tensioner Block.
- d) Work your way around the clothesline removing all 4 Terminal Blocks Tops and the line.

ROTARY CLOTHESLINE V1.0

M32/M38/M42/M48/M52/M58

Daytek®

To attach a new line,

- Start by clamping one end of the new line into ARM 1 as shown below (ARM 1 can be any arm you choose).
- Work your way around the clothesline attaching the line at ARM 2, 3 & 4 as shown below. Ensure line is pulled tight and clamped in Tensioner Block before moving on to next arm.
- When you arrive back at ARM 1, remove the Tensioner Block Top and clamp both line ends into line tensioner as shown below, making sure the lines are pulled tight.
- Trim line ends leaving approximately 5cm.

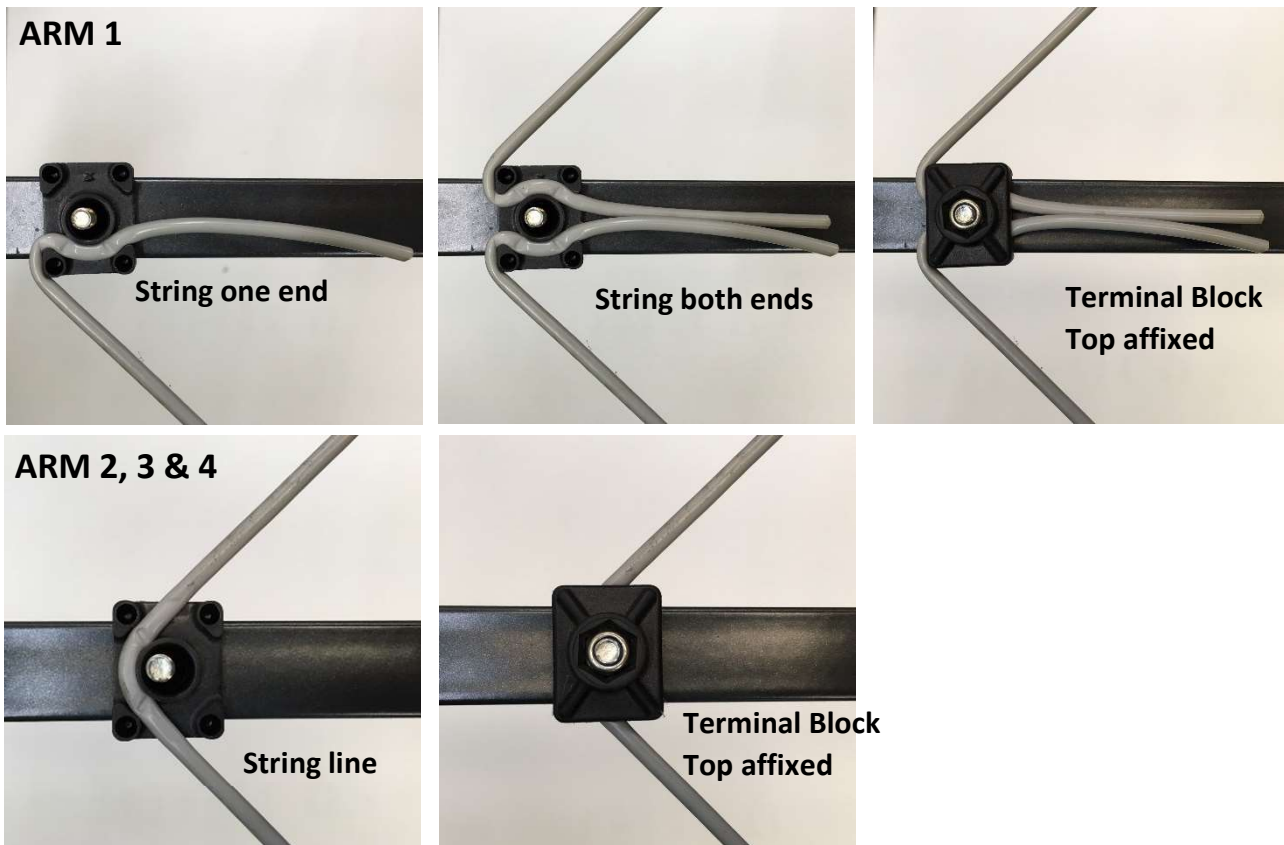

HOW TO RE-TENSION THE LINE ON A DAYTEK ROTARY CLOTHESLINE

- At the required tensioning point, place your index finger on top of the Tensioner Block Top and over the Nut to ensure that the Nut is held in position.
- Loosen the bolt from under the arm of the clothesline.
- Pull the line through the Tensioner Block to required tension and re-tighten the bolt.
- Repeat this process around the clothesline working your way towards the end of the line.