

## PRODUCT MANUAL

### Mk 2 Rotary Clotheslines



**IMPORTANT** - READ THESE INSTRUCTIONS  
BEFORE USING YOUR CLOTHESLINE

**Suitable for models**

**M32 / M38 / M42 / M48 / M52 / M58**

Product Code	
Date of purchase	
Name & location of supplier	

R0619-V1

# BEFORE YOU BEGIN

**Note: We recommend two persons to install this product**

**Please check that the carton contains all the required parts before assembly.**

Your carton should contain the following:

- A - Main Tube Assembly
- B - Hoist Tube Assembly
- C - Ground Socket and Cap
- D - Bonus Peg Bag
- E - Bonus Pegs (12 pcs)
- F - Bonus Rotary Storage Bag
- G - Bonus Sock Holder

**Tools and materials required for installation:**

- Medium aggregate screenings (crushed rock)
- 20kg bags of pre-mix concrete x 2
- Wooden or metal stakes 400mm long x 3
- Length of rope approximately 2 meters long x 3
- Spirit Level

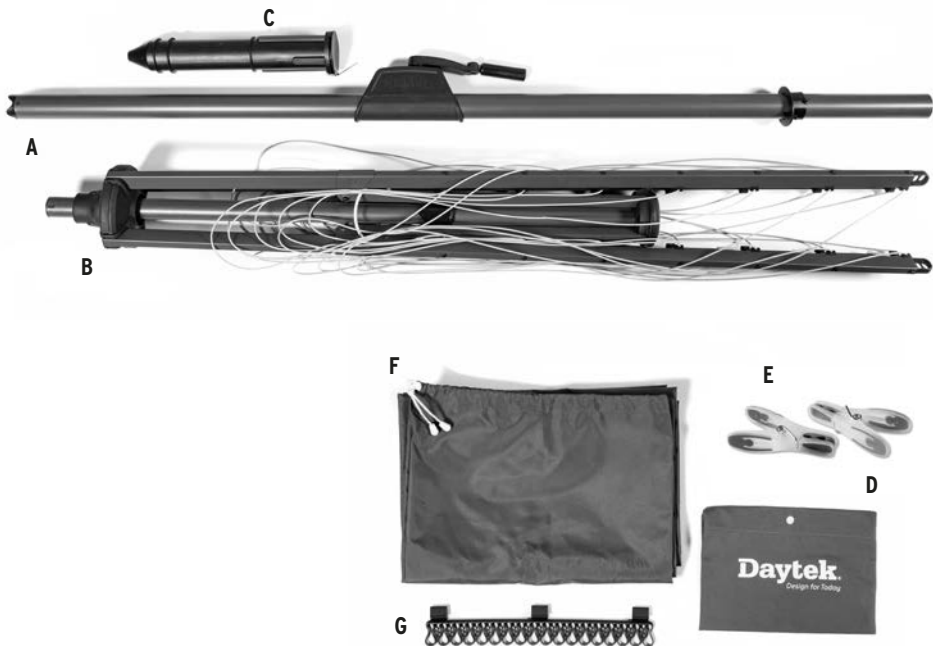

## PREPARING THE SITE FOR YOUR ROTARY CLOTHESLINE

### Preparing the ground socket

1. **Make sure the selected installation position has a minimum of 3 meters clearance on all sides from the central location.**
2. **Excavate a hole 250mm in diameter x 600mm deep.**
3. **Back fill the hole with screenings (small crushed rock) to 450mm from ground level.** This is necessary to drain rain water that enters via the socket.
4. **Position the the ground socket inside the hole so that it sits centrally and vertically.** The bottom end of the ground socket will rest on the screenings while the top of the ground socket should reach the ground level. Adjust the depth of the screenings as needed.
5. **To retain the ground socket in the central position, backfill with screenings to 425mm from ground level.** Ensure no rocks are inside the socket.

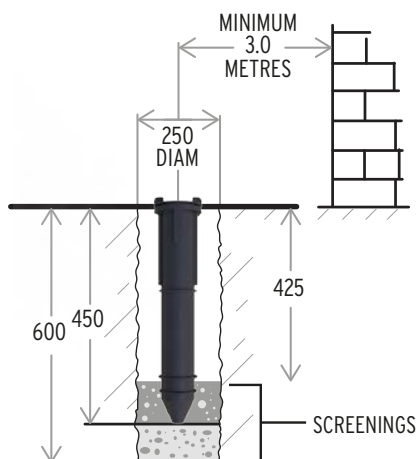

### Positioning the main tube assembly

6. **Position 3 stakes spaced at an equal distance around the hole approximately 1 meter out.** Insert the stakes at an angle approximately 300mm into the ground.
7. **Insert the main tube assembly into the ground socket making sure the pin is positioned into one of the slots.** Secure by engaging the locking ring. (See Fig. 1 - 4)

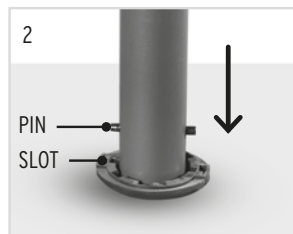
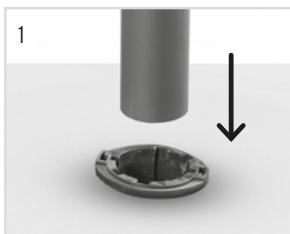

### Securing the main tube assembly

8. Tie a length of rope from each stake to the main tube assembly to secure it vertically. Check that the tube is sitting vertically using a spirit level.
9. Prepare the pre-mix concrete and backfill the hole with the concrete mix. Gently compact the concrete.
10. Ensure the concrete is underneath the top lip of the ground socket.
11. Re-check that the main tube assembly is still vertical. Leave for 24 hours to set concrete before assembling the hoist tube.

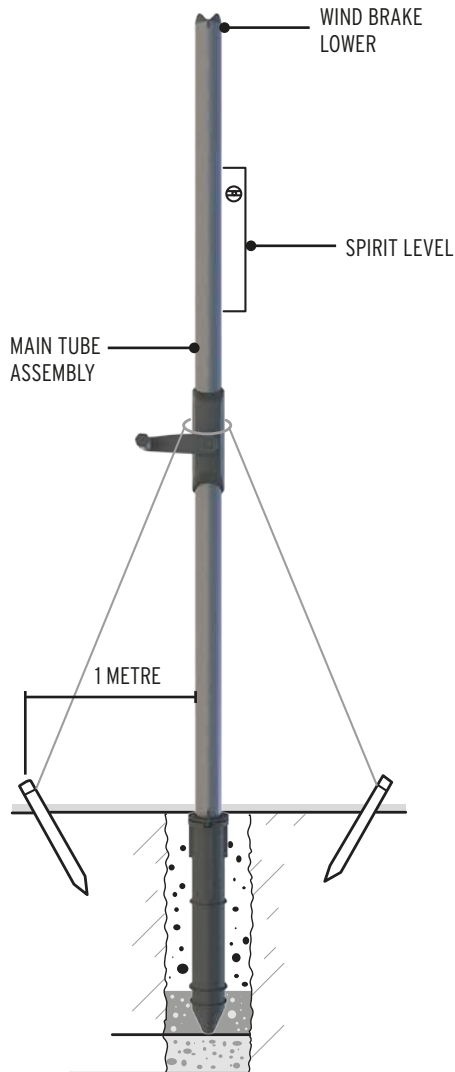

## ASSEMBLING YOUR ROTARY CLOTHESLINE

1. **Once the concrete is dry, remove the cord and stabilising stakes.**
2. **Gently slide the hoist tube assembly into the main tube assembly until the units engage together.** The tube assemblies are engaged when both the upper and lower wind brake face meet. (See Fig. 1)
3. **Lock handle into final position by pulling upwards on the handle grip.** (See Fig. 2 - 3)
4. **Each clothesline arm is secured with a plastic cable tie.** Carefully cut and remove each one making sure not to cut or damage the clothesline cord. (See. Fig. 4)
5. **The clothesline cords are secured to each arm with a rubber band.** Cut and remove these bands making sure not to damage the clothesline cord. (See. Fig. 5)

HOIST TUBE  
ASSEMBLY

MAIN TUBE  
ASSEMBLY

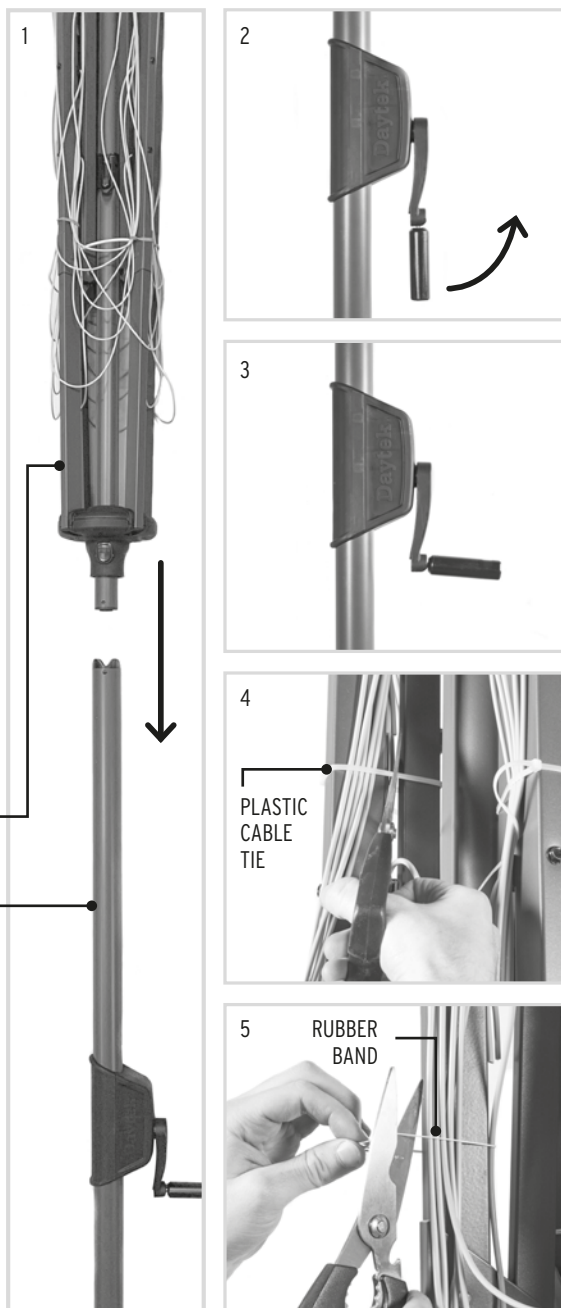

# OPERATING YOUR ROTARY CLOTHESLINE

1. Slide the yellow ring upwards, this allows the arms to be folded out to horizontal position where the dual latches will lock the arms in place. (See Fig. 1 - 3)

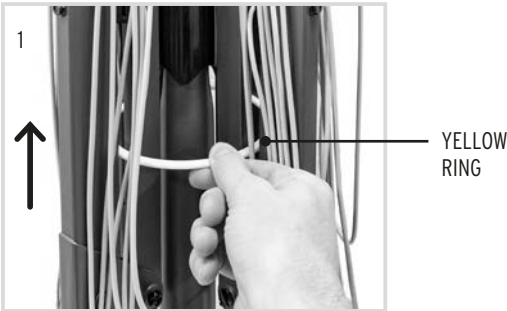

2. Push the clothesline hoist up into the open position. To do this, hold the Slide and push upwards until the hoist “clicks” into the open position. (See Fig. 4 - 5)



3. **To raise the hoist for 'free spinning' wind drying, simply rotate the handle in a clockwise direction to disengage the wind break.** (See Fig. 6 - 7)

**To activate the wind brake, turn the handle anti-clockwise until the two serrated plastic faces meet.** This will lock the clothesline head and prevent the hoist from freely spinning. (See Fig. 8 - 9)

*Note: There is a safety clutch within the gear box. When the clothesline is in maximum lowest or highest position the handle will rotate freely (clicking sound), which prevents damage to the gear box.*

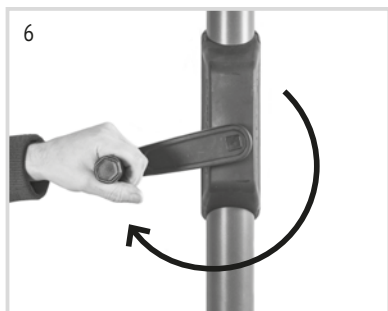

WIND BRAKE DISENGAGED



WIND BRAKE ENGAGED

## FOLDING AWAY YOUR ROTARY CLOTHESLINE

1. **Wind down the clothesline to the wind break position.**
2. **Use one hand to push the release buttons on the Slide whilst pulling down on the Central Hub with your other hand.** Once the catch disengages you can move the Slide downwards until all four arms are folded vertically. (See Fig. 1 - 3)
3. **Allow the yellow ring to drop down, securing the arms into the folded position.**
4. **If the clothesline will be left unused for an extended period of time you can utilise the Rotary Storage Bag.**

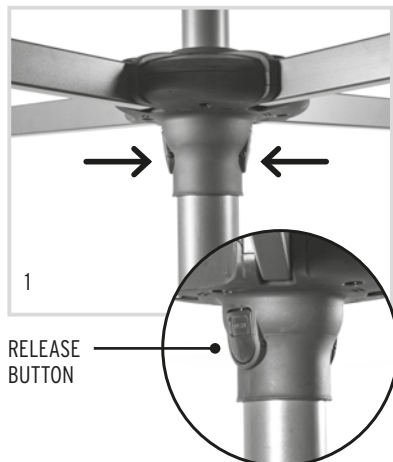

PRESS BUTTONS EACH SIDE OF HUB



PULL DOWN LIGHTLY ON HUB





## ADJUSTING THE HEIGHT OF YOUR ROTARY CLOTHESLINE

The ideal height of the clothesline should be approximately 50mm from the users head to the underside of the horizontal arms.

To adjust the clothesline to higher position simply remove the support ring from the ground socket, lift the clothesline and rotate to either slot 1, 2 or 3. Each position will increase your clothesline height by 75mm. With the clothesline at the required height replace the support ring into the ground socket to secure the clothesline.



## HELPFUL HINTS

- Engage the wind brake mechanism while hanging laundry. By pulling sideways on the horizontal arms the clothesline will rotate to the next loading position.
- Hang washing starting from the inside line with small garments.
- Distribute the weight of the washing evenly on each line around the four quadrants
- After hanging the washing it is important to wind the line up off the wind brake for spin air drying.
- Located at the end of each horizontal arm is a clothes hanger loop.

## IMPORTANT

Please ensure your clothesline is not used as a playing item by children swinging on lines and main arms. Any damage from misuse will void the warranty.

## HOW TO RESTRING/REPLACE THE LINE ON YOUR DAYTEK ROTARY CLOTHESLINE

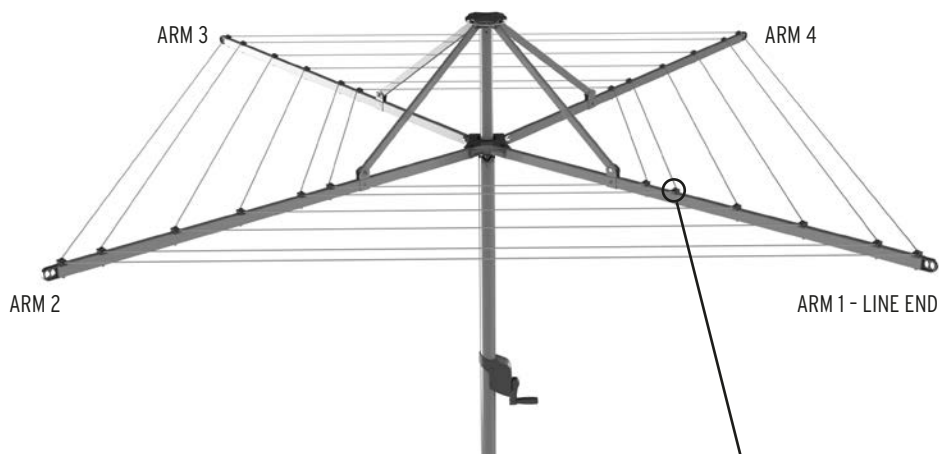

**A. Tensioner Block Bottom** - recessed into the arm of the clothesline.

**B. Tensioner Block Top** - positioned on top of the bottom block.

**C. Bolt** - head of bolt under the arm of the clothesline.

**D. Nut** - seated in the top of the line tensioner.

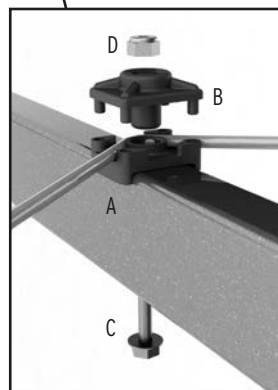

**TO REPLACE A LINE ON YOUR DAYTEK ROTARY CLOTHESLINE, YOU MUST REMOVE THE TENSIONER BLOCK TOPS OFF THE AFFECTED LINE.**

### To remove the Tensioner Block Tops

1. Place your index finger on top of the Tensioner Block and over the Nut to ensure that the Nut is held in position.
2. Undo and loosen the bolt from under the arm of the clothesline. Once the bolt is fully loose, you can carefully remove the Tensioner Block Top & Nut.
3. Remove the line from the Tensioner Block.
4. Work your way around the clothesline removing all four Terminal Blocks Tops and the line.

## To attach a new line

1. Start by clamping one end of the new line into **ARM 1** as shown below (ARM 1 can be any arm you choose).
2. Work your way around the clothesline attaching the line at **ARM 2, 3 & 4** as shown below. Ensure line is pulled tight and clamped in Tensioner Block before moving on to next arm.
3. When you arrive back at **ARM 1**, remove the Tensioner Block Top and clamp both line ends into line tensioner as shown below, making sure the lines are pulled tight.
4. Trim line ends leaving approximately 5cm.

### ARM 1



STRING ONE END



STRING BOTH ENDS



TERMINAL BLOCK TOP AFFIXED

### ARM 2, 3 & 4



STRING LINE



TERMINAL BLOCK TOP AFFIXED

## HOW TO TENSION THE LINE ON YOUR DAYTEK ROTARY CLOTHESLINE

1. At the required tensioning point, place your index finger on top of the Tensioner Block Top and over the Nut to ensure that the Nut is held in position.
2. Loosen the bolt from under the arm of the clothesline.
3. Pull the line through the Tensioner Block to required tension and re-tighten the bolt.
4. Repeat this process around the clothesline working the slack cord towards the end of the line.

## CARE AND MAINTENANCE

---

If you are living within close proximity to a seaside location, salt in the air will build up a thin layer on your clothesline over time. To ensure longevity it is important to regularly wipe down the surface of your clothesline with a damp cloth.

Regularly check your clothesline for damage or wear and tear. Any damaged part should be replaced or repaired before using again. A full range of spares are available through Daytek. Wipe away dust and dirt regularly to prevent build up and ensure smooth operation.

## 25 YEAR PRODUCT WARRANTY

---

Our goods come with guarantees that cannot be excluded under the Australian Consumer Law. You are entitled to a replacement or refund for a major failure and for compensation for any loss or damage. You are also entitled to have the goods repaired or replaced if the goods fail to be acceptable quality and the failure does not amount to a major failure.

If any part of this clothesline fails to operate correctly due to faulty workmanship or defective material Daytek Australia will repair or replace free of cost within 25 years from the original date of purchase (receipt of purchase required). The PVC line cord is covered by a 2 year warranty from the date of purchase. Any evidence of misuse or incorrect adjustment will void the warranty. To claim a product warranty, please contact Daytek Australia

directly. You must bear the cost of claiming the warranty. This warranty is in addition to other rights and remedies of the customer under law.

Where it is deemed necessary, Daytek Australia will arrange for the inspection of your product.

### Warranty exclusions

Defects caused by incorrect installation (including poor drainage from ground socket), adjustment, modification or misuse. Paint deterioration caused by exposure to sea air where the product is installed in coastal areas. Product damage or deterioration due to abnormal environmental conditions including storm damage, fire, wind, humidity and similar. Damage to frame or line through accident or negligence. Warranty does not cover bonus items.

The warranty covers domestic use only and does not apply to commercial applications.

## CONTACT DAYTEK

---



[enquiry@daytek.com.au](mailto:enquiry@daytek.com.au)



[daytek.com.au](http://daytek.com.au)



[facebook.com/daytekAU](https://facebook.com/daytekAU)



[www.productreview.com.au/listings/daytek](http://www.productreview.com.au/listings/daytek)

Manufactured/Supplied by Daytek Australia Pty. Ltd.

77-81 Gower Street, Preston

Victoria 3072 Australia

T +61 3 9470 1755

F +61 3 9470 5381

E [enquiry@daytek.com.au](mailto:enquiry@daytek.com.au)

**daytek.com.au**



**Daytek**<sup>®</sup>  
Design for Today