

PRODUCT MANUAL

Easy Lock Fold Down Clotheslines



Single Model Pictured

IMPORTANT - READ THE PRODUCT MANUAL BEFORE USING YOUR CLOTHESLINE

SUITABLE FOR MODELS

MINI 7.5m

SLIM 11m

SINGLE 22m

Product Code	
Date of purchase	
Name & location of supplier	

1219-V2

BEFORE YOU BEGIN

Please check the carton contains all the required parts before assembly.

Your carton should contain the following:

- A.** Wall Bracket x 2
- B.** Side Arm & Strut Assembly x 2
- C.** Front Bar x 1
- D.** Corner Brackets x 2
- E.** Wall attachment template (to suit your clothesline) x 1
- F.** Wall Bracket Assembly Nuts & Bolts x 4
- G.** Wall Bracket Bushes x 8
- H.** Corner Bracket Assembly Nuts & Bolts x 4
- I.** Line Cord x 1
- J.** Easy Lock Line Tensioner x 1

Identify the type of installation required.

- 1. Wall mounting installation** - follow Wall mounting installation below
- 2. Free standing** - use Daytek Ground Mount Kit
*Sold separately (available in standard in ground installation or with base)

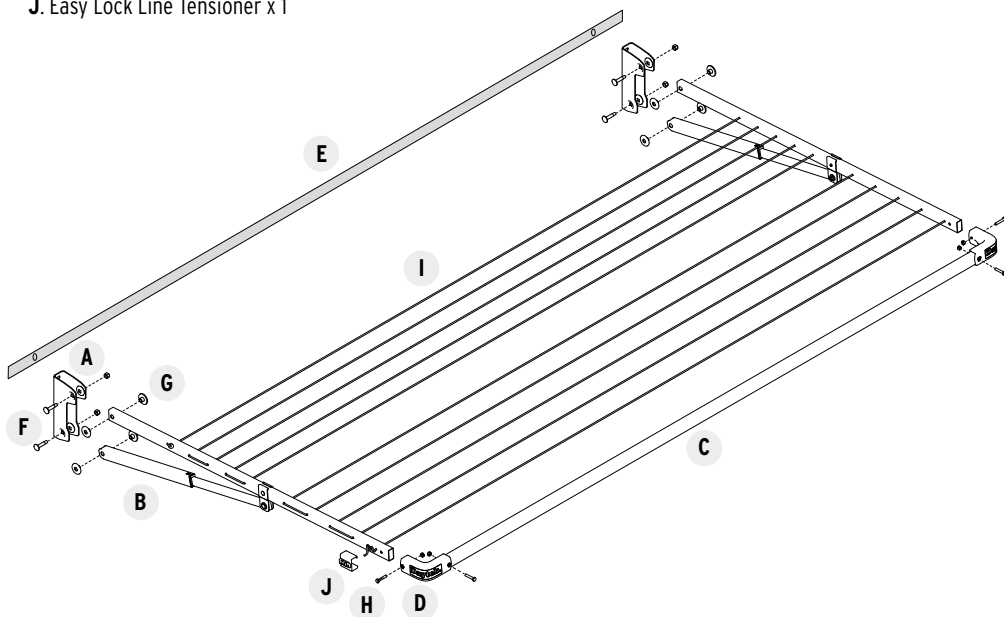

WALL MOUNTING INSTALLATION

Tools required for installation:

- 13mm spanner
- 10mm spanner
- Spirit level
- Tape measure
- Pencil
- Hammer drill + suitable drill bit
- Wall fixings (to suit your chosen installation surface)
- Scissors

Important:

Mounting hardware required will vary depending on the surface of the wall the Clothesline will be mounted to.

When mounting to concrete, brick or masonry walls we recommend **Daytek 8mm Marine Grade Anchor Bolts** (Sold separately).

For wood or other specialised materials please consult your local hardware store or professional for advice.

Never attach clothesline to mortar between brickwork. Ensure fixing surface is structurally sound.

Install away from Heating or Cooling Units.

INSTALLATION PROCEDURE

1. MOUNTING LOCATION

For best drying results, select a location that receives maximum sunlight and airflow.

Ensure that the area has sufficient clearance around the clothesline. We recommend 100mm clearance each side and 500mm in front of clothesline frame when open (refer to frame size on page 1 of manual).

Mounting Width

Centre to centre fixing points for installation,
Mini – 1520mm / Slim, Single – 2220mm

Mounting Height

The recommended mounting height for the top hole in the wall bracket is:

User height +100mm
Minimum mounting height 1500mm

Note: always consider the main users height and the length of the items you plan on drying.

FIGURE 1

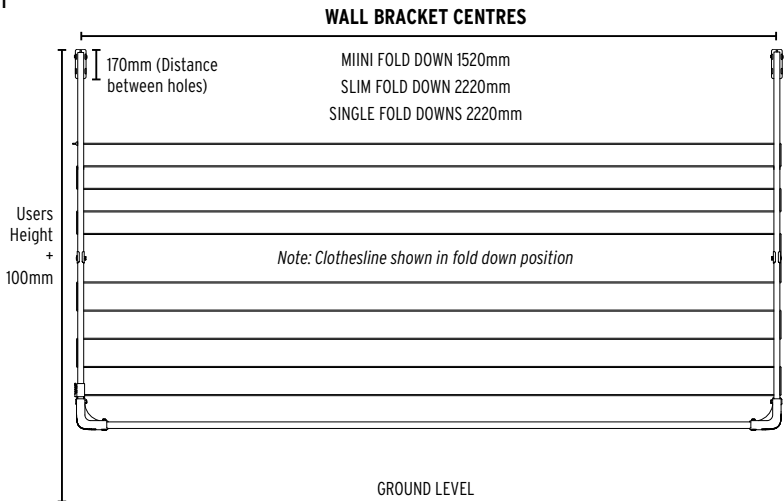

INSTALLATION PROCEDURE (Continued)

2. MOUNT THE WALL BRACKETS

- 2.1 **Use a Wall Bracket as a guide to mark the fixing hole positions for one side of the clothesline.** (See Figure 2A)

Make sure to align the top hole of the Wall Bracket with your height marker. Ensure that the holes are vertically level. (See Figure 2B)

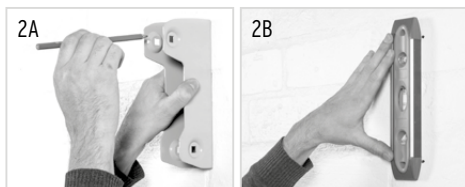

- 2.2 **Drill the marked hole positions to suit your wall fasteners.**

If you are using an anchor bolt, tap the bolt into the holes as per the manufacturer's instructions. Alternatively, if you are using an anchor screw, insert the screw slightly into the hole to complete step 2.3.

- 2.3 **To mark the second wall bracket location, slide one end of the Wall Attachment Template over the top fixing (See Figure 2C), pull tight and to the side (See Figure 2D) and mark the wall bracket centre distance (See Figure 2E).**

Ensure that the template is level and taught before marking the location.

Note: we always recommend to confirm the correct hole position with a tape measure and spirit level before drilling. Confirm measurement against Figure 1.



- 2.4 **Mark both fixing hole positions for the second side of the clothesline using the Wall Bracket as a template (See Figure 2F).**
Drill the marked holes to suit your fixings.

- 2.5 **Secure both Wall Brackets firmly to the wall.** (See Figure 2G).

IMPORTANT! Ensure the head of the wall fixings do not protrude more than 13mm.

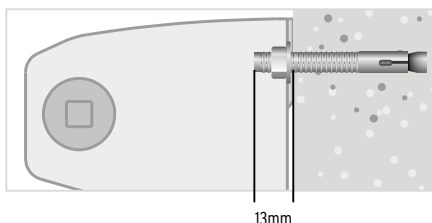

3. ATTACH SIDE ARMS AND STRUTS

- 3.1 **Press 4 x Wall Bracket Bushes into each Side Arm & Strut Assembly** (See Figure 3A)
- 3.2 **Fasten a Side Arm & Strut Assembly to each Wall Bracket using the supplied Nuts & Bolts (13mm)** (See Figures 3B-3D)

NOTE: Do not overtighten the nuts. The Side Arm & Strut must be free to pivot. If the assembly is overtightened your clothesline may not operate correctly.

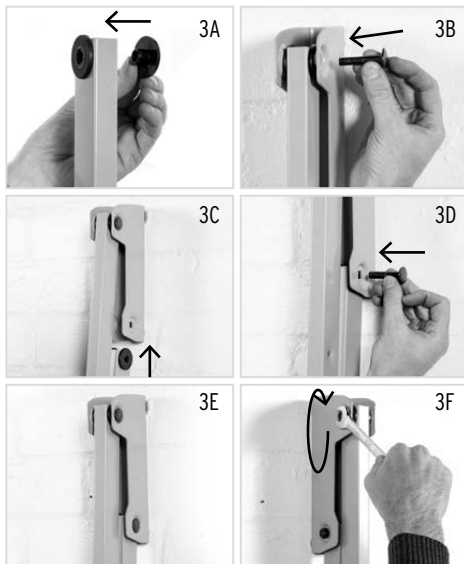
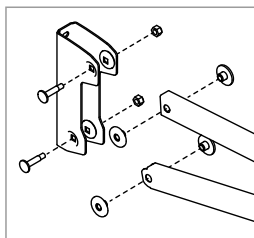

4. INSTALL FRONT BAR

- 4.1 **Attach the Corner Brackets to the Front Bar and secure with nuts & bolts (10mm)** (See Figure 4A-4C).
- 4.2 **Lock each side arm into the upright position.** To do this gently lift each Side Arm upwards to the maximum point of travel and then release. (refer to lifting and folding diagrams)
- 4.3 **Install the Front Bar to the Side Arms and secure with nuts & bolts** (See Figure 4D-4E).

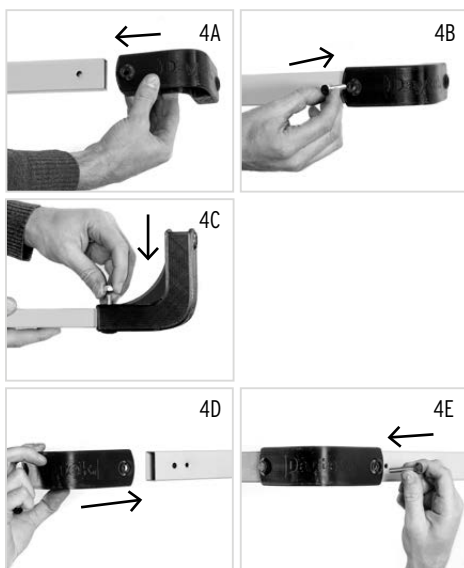
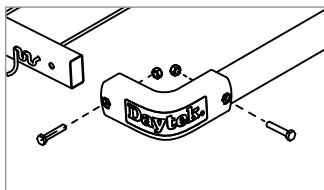

INSTALLATION PROCEDURE (Continued)

5. THREAD CLOTHESLINE AND TENSION

- 5.1 Thread the cord through the inner most hole (closest to wall) and tie off with a knot (see Figure 5A).
- 5.2 Continue threading the cord from the inner most hole up to the last hole position (see Figure 5B).
- 5.3 Thread the end of the cord through the Line Tensioner (see Figure 5C).

- 5.4 Progressively pull each line tight working the slack from the rear line to the front line.

- 5.5 Pull the cord tight through the tensioner and lock into place (see Figure 5C).

- 5.6 Trim off excess cord with scissors.

Note: Do not over-tension the cord as this can put excessive pressure on the side arms and could affect the smooth operation of your clothesline. Having some slack in cord is ok provided your items of washing are clear from touching the ground.

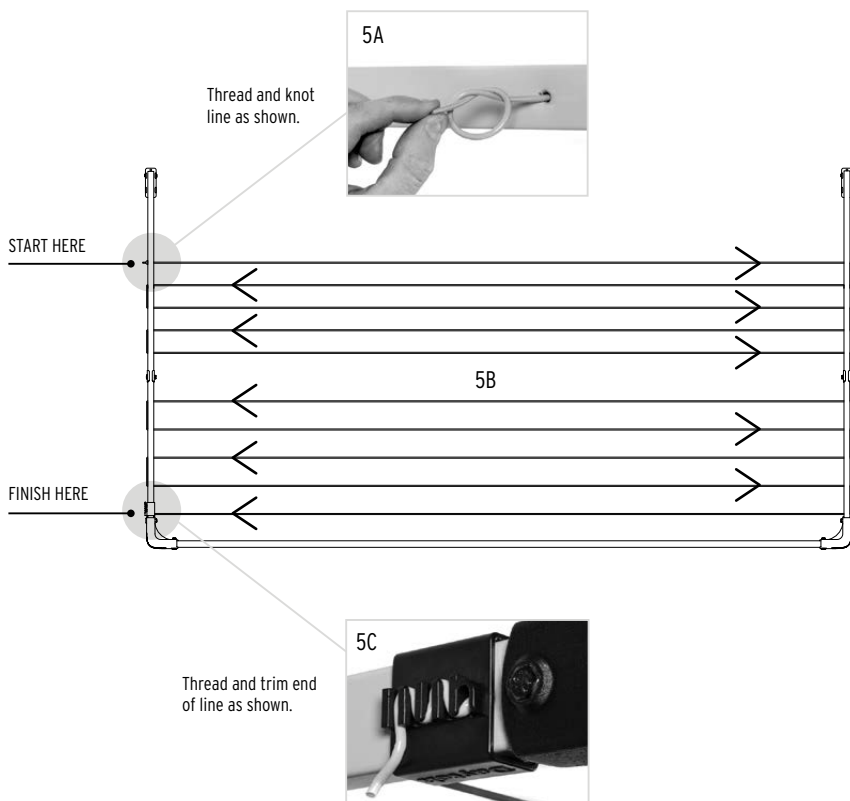

OPERATING THE CLOTHESLINE

TO RAISE

Grip the centre of the Front Bar with one or two hands as shown below.

Gently raise the bar to the maximum point of travel and then release. The clothesline will lock into the upright position. *Note: Do not force the frame higher than its maximum point of travel.*

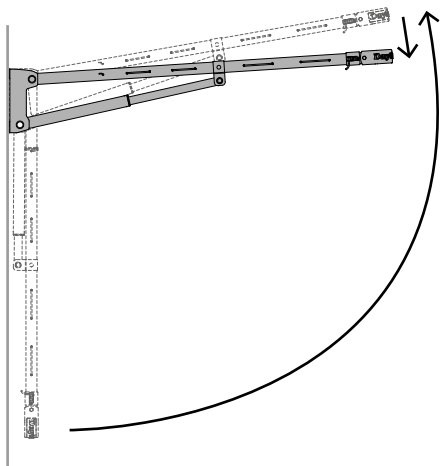

TO LOWER

Grip the centre of the Front Bar and gently lift the clothesline upwards to the maximum point of travel. This will unlock the strut mechanism allowing it to fold down flat.

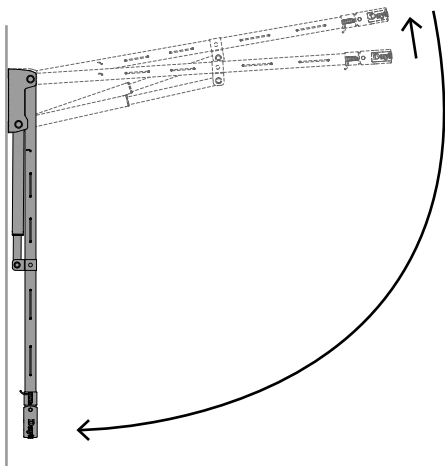

Note: Raising the frame without gripping the centre may result in only one strut locking. If this occurs, raise the frame on the unlocked side only and then gently release. The arm should now be locked into place (Due to the design of our Easy Lock strut there is no clicking or audible sound when the lock is engaged, it will simply engage/disengage after being lifted to the maximum point).



IMPORTANT! Maximum recommended loading of this clothesline is 1kg per meter of line. Refer to your individual clothesline for specified line space.

CORD TENSIONING

Over time the cord may stretch causing the lines to sag. To remove excessive slack from the line, start at the rear line and work your way to the front line to remove all the slack. Whilst holding the excess line, release the cord from the tensioner and pull the slack through before locking back into place.

Note: Do not over tension the line as this may bow the side arms and affect the clotheslines operation.

Having some slack in your cord is not a bad thing provided your items of washing are clear from touching the ground.

15 YEAR PRODUCT WARRANTY

Our goods come with guarantees that cannot be excluded under the Australian Consumer Law. You are entitled to a replacement or refund for a major failure and for compensation for any loss or damage. You are also entitled to have the goods repaired or replaced if the goods fail to be acceptable quality and the failure does not amount to a major failure.

If any part of this clothesline fails to operate correctly due to faulty workmanship or defective material Daytek Australia will repair or replace free of cost within 15 years from the date of purchase. (Receipt of purchase required). The PVC line cord is covered by a 2 year warranty from the date of purchase. Any evidence of misuse or incorrect adjustment will void the warranty. To claim a product warranty, please contact Daytek Australia

CARE AND MAINTENANCE

If you are living within close proximity to a seaside location, salt in the air will build up a thin layer on your clothesline over time. To ensure longevity it is important to regularly wipe down the surface of your clothesline with a damp cloth.

Wipe away dust and dirt from the telescopic strut regularly to prevent build up and ensure smooth operation.

Regularly check your clothesline for damage or wear and tear. Any damaged part should be replaced or repaired before using again. A full range of spares are available through Daytek.

directly. You must bear the cost of claiming the warranty. This warranty is in addition to other rights and remedies of the consumer under law.

Where it is deemed necessary, Daytek will arrange for the inspection of your product.

Warranty exclusions

Defects caused by incorrect installation, adjustment, modification, overloading or misuse. Paint deterioration caused by exposure to sea air where the product is installed in coastal areas. Product damage or deterioration due to abnormal environmental conditions including storm damage, fire, wind, humidity and similar. Damage to frame or line through accident or negligence.

The warranty covers domestic use only and does not apply to commercial applications.

Manufactured/Supplied by Daytek Australia Pty. Ltd.

77-81 Gower Street, Preston

Victoria 3072 Australia

T +61 3 9470 1755

F +61 3 9470 5381

E enquiry@daytek.com.au

daytek.com.au



Daytek®
Design for Today